

Echelon™ Cycle Shelter

GROUND FIXING & END PANEL INSTALLATION INSTRUCTIONS

IMPORTANT NOTE: ENSURE THAT ALL RELEVANT PERSONNEL READ THESE INSTRUCTIONS PRIOR TO USE

Please also refer to the 'Manual Handling Operations Regulations 1992' during the handling of the product and materials used for installation. Glasdon recommends that a full Health and Safety analysis is carried out prior to installation.

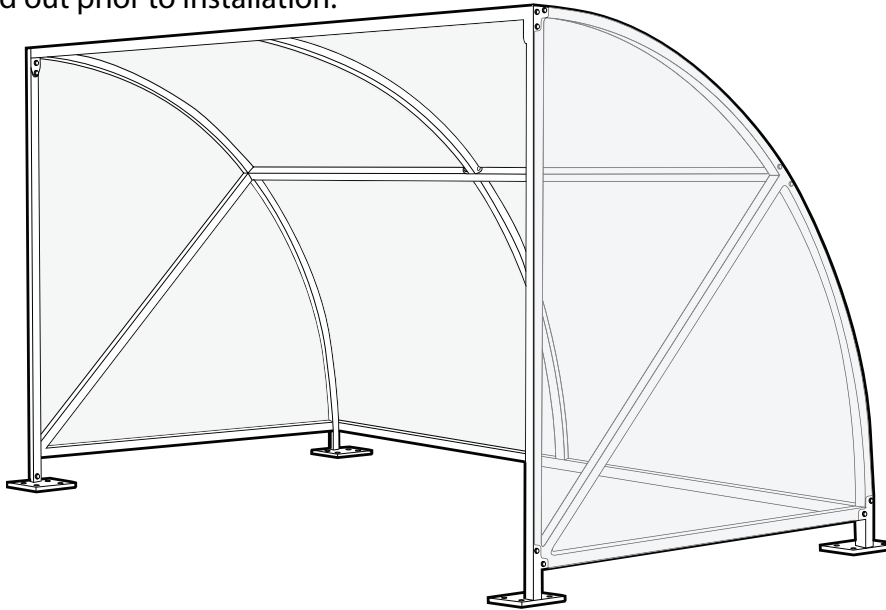

GROUND FIXING KIT CONTENTS

- ITEM 1 - Self Tapping Anchor Bolt (M10 x 100mm) x12
- ITEM 2 - Washer (M12 x 23mm) x12

TOOLS/EQUIPMENT REQUIRED:

- 4mm Allen Key (Supplied)
- Drill + Ø10mm masonry drill bit.
- 17mm socket + Socket wrench.
- Spiral brush + Air blower (Optional)

OPTIONAL END PANEL FIXING KIT CONTENTS:

	1 Panel Kit	2 Panel Kit
ITEM 3 - 3mm Polycarbonate End Panel	x 1	x 2
ITEM 4 - Socket Button head screw (M6 x 20mm)	x 39	x 78
ITEM 5 - Spring Washer M6	x 39	x 78
ITEM 6 - Penny Washer (M6 x 25mm)	x 39	x 78
ITEM 7 - Spacer (M6 x 10 x 3mm)	x 39	x 78

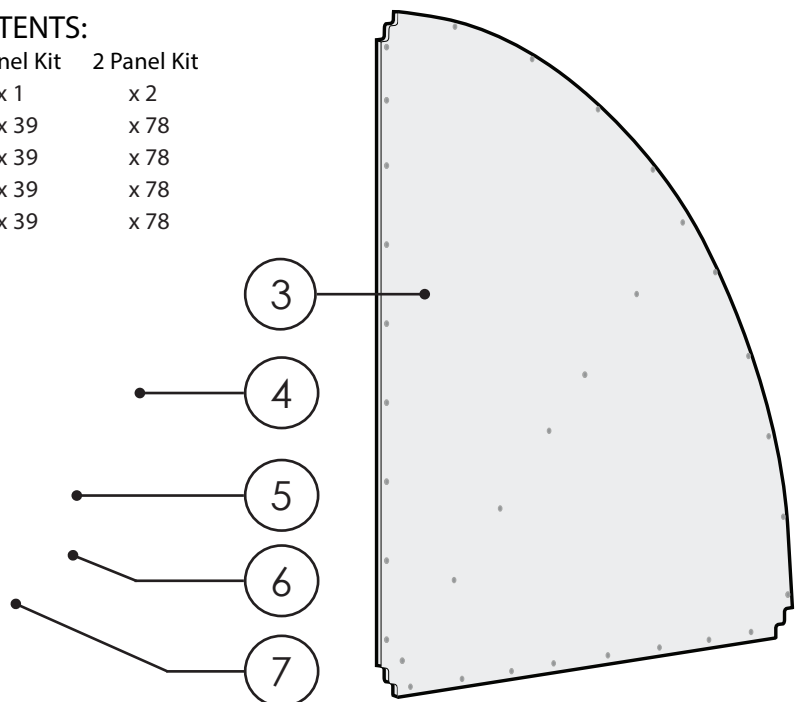
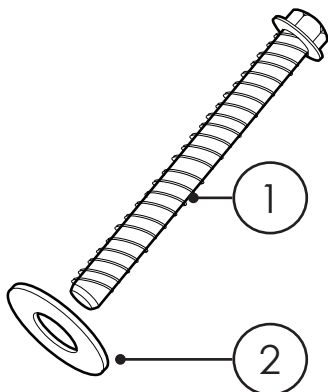
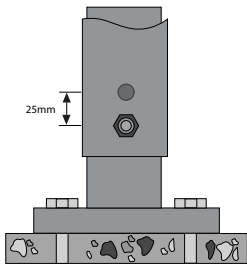
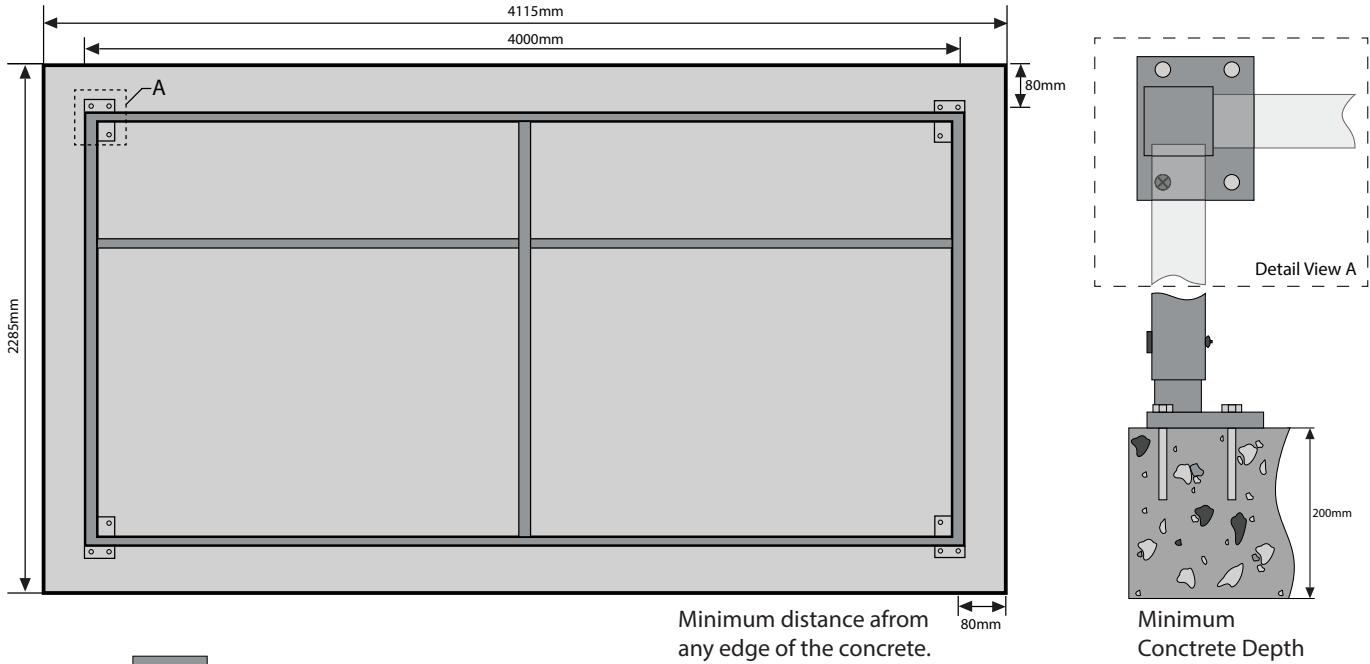

DIAGRAM NOT TO SCALE

INSTALLATION - GROUND FIXING INSTRUCTIONS

Concrete Surface Mount



Adjustable Feet

In cases of uneven ground, use the adjustable feet to level the shelter. Using the socket wrench, untighten the fixing.

Use a pump truck or available lifting equipment to raise the shelter to the desired level. Place the fixing through the chosen level hole and tighten using the socket wrench.

To fully secure overtighten the fixing using a socket wrench to break off the shear nut head.

For optimum fixing performance the following procedure is recommended.

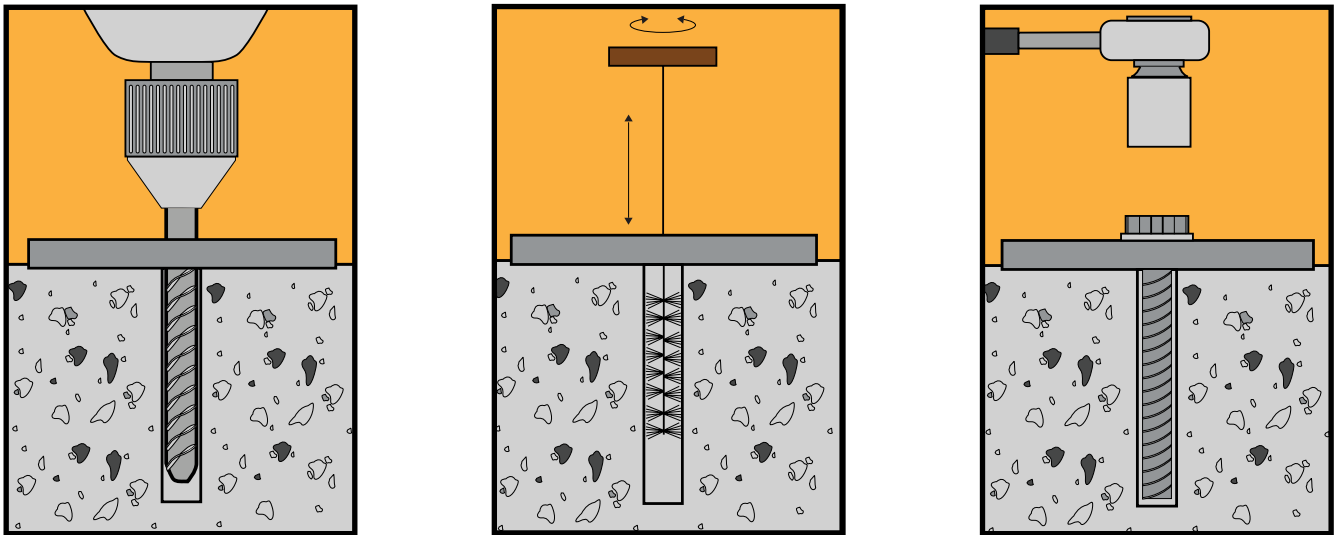

The base should be flat, steel float finished, level and square and preferably be raised slightly above the surrounding ground level.

The concrete base should be a minimum 25N/20mm mix strength equivalent of BS. 5328, Section 2, Part 10, Grade C25.

Using the supplied unit as a template, drill through 3 of the 4 (**See Detail View A**) base fixing positions in each of the feet with a 10mm masonry drill to a minimum depth of 120mm.

Clean drill hole thoroughly using a spiral brush and remove all dust using a blow out pump, airline or similar.

Insert the ground fixing and washer into the drilled hole and tighten with Socket and Wrench Set.

ASSEMBLY

Optional Polycarbonate End Panels

1

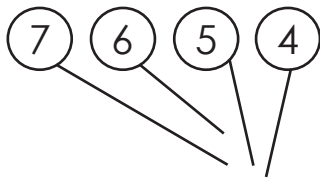

Assemble the required amount of fixings needed for the end panels by placing items 5,6 and 7 over item 4.

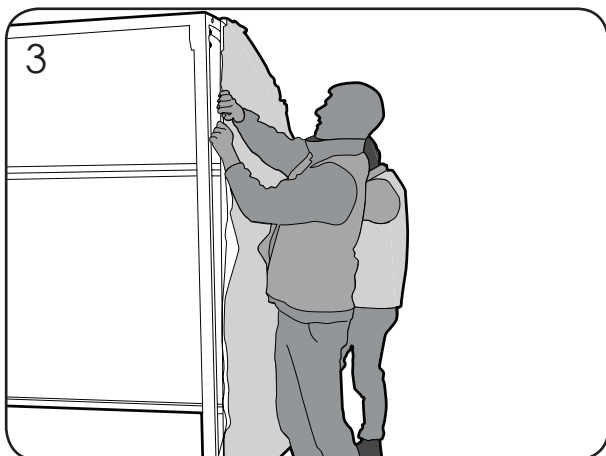

Lift the panel up against the frame and align the holes with the fixing points in the frame.

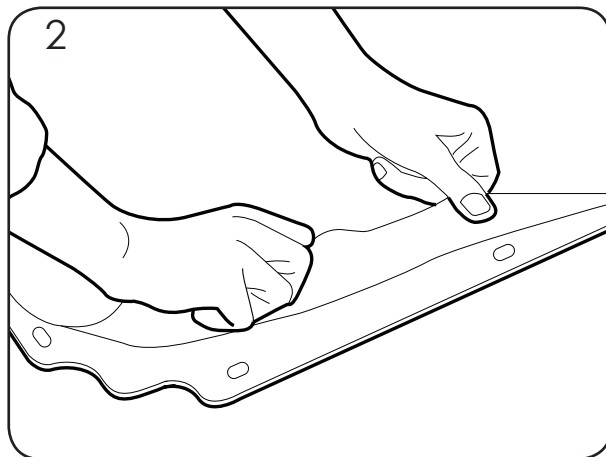

On the outside of the panel, peel back the protective film around the perimeter of the polycarbonate panel (Item 3) to reveal the fixing holes. On the inside of the panel remove the protective film entirely.

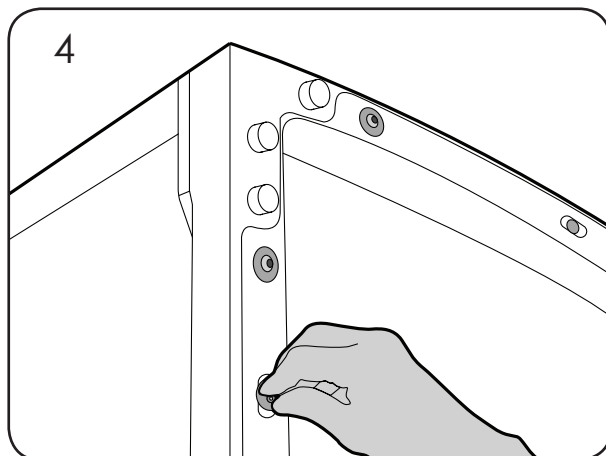

Insert the assembled fixings into the holes in each corner of the panel and hand tighten to temporarily secure it in place.

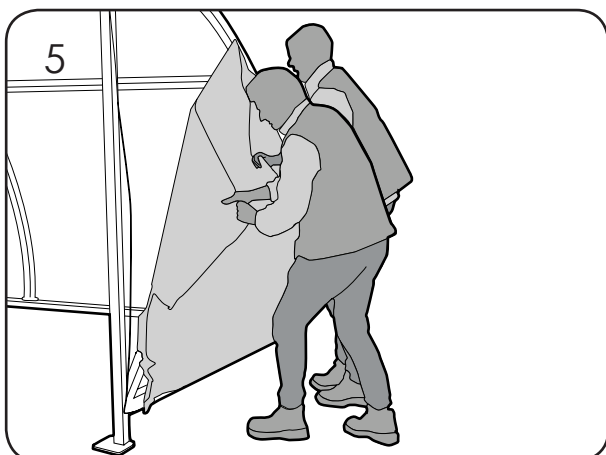

Remove the remaining protective film from the panel.

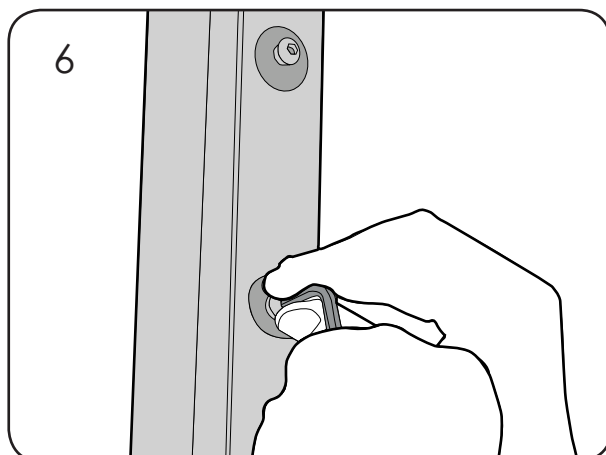

Insert the remaining fixings into each of the holes and tighten using the allen key to secure the panel. Repeat around the perimeter, ensuring all fixings are secure*.

***NOTE: Take care, do not overtighten. If using a torque wrench or drill to tighten - a force of no more than 10Nm is required.**

IMPORTANT NOTE: PLEASE ENSURE THAT ALL RELEVANT PERSONNEL READ THE POINTS LISTED WITHIN THIS LEAFLET AND THAT A COPY IS GIVEN TO STAFF INVOLVED WITH THE INSTALLATION AND MAINTENANCE OF THIS PRODUCT.
SAFETY NOTE: PLEASE REFER TO 'THE MANUAL HANDLING OPERATIONS REGULATIONS 1992' DURING HANDLING.

 **Glasdon** AND GLASDON ECHELON ARE TRADEMARKS OR REGISTERED TRADEMARKS OF GLASDON GROUP OR ITS SUBSIDIARIES IN THE U.K. AND OTHER COUNTRIES.

- A planned maintenance schedule or regular inspection is recommended, replacing components as necessary.
- Replacement components are available direct from GLASDON.
- GLASDON cannot be held responsible for claims arising from incorrect installation, unauthorised modifications or misuse of the product.

Stock No. C000/1034 - DWG No. 12B-112-13 Issue 3 - October 2018

© Copyright 06/2018

Glasdon UK Ltd reserve the right to alter specifications without prior notice.

 **Glasdon**[®]
Glasdon U.K. Limited
Preston New Road
BLACKPOOL
Lancashire
FY4 4UL
Tel: (01253) 600410
Fax: (01253) 792558
e-mail: sales@glasdon-uk.co.uk
web: www.glasdon.com